



BEACHSIDE

VILLA & RESORT

EVERYDAY IS A HOLIDAY

Project by:
 SERENITY
CENTRAL
CITY

Developed by:
 CENTRAL
GROUP



Shows the growth in foreign visitor numbers from 2017 to December 2023 according to the four main entrances.

PROMISING TOURISM DESTINATION



Batam Port is ranked 1st position as the entry point for the most foreign tourists by sea transportation mode

Source: Badan Statistik Pusat Kota Batam (Update Februari 2024) <https://www.bps.go.id/id/statistics-table/2/NTE1MCMY/jumlah-kunjungan-wisatawan-mancanegara-per-bulan-ke-indonesia-menurut-pintas-masuk-2017--sekarang.htm>

EASY ACCESS

BATAM HAS **5 INTERNATIONAL SEAPORTS** and **HANG NADIM INTERNATIONAL AIRPORT** with the longest runway in Indonesia and the second longest in Southeast Asia.

Batam Entrepreneurs Association





HARMONY OF SEKUPANG

Disclaimer: All contents, forms and images in this Product Knowledge constitute general information related to the product which is still in the preliminary design stage. Changes in content, forms and images can occur at any time without prior notification, and full right of the developer. This presentation purposes only and cannot be used as legal evidence.



to Serenity Day Club
Only 5 mins



to Dangas Beach
Only 5 mins



to Tebing Langit Park
Only 5 mins



to Sekupang Deer Park
Only 10 mins



to Sekupang Ferry Terminal
Only 10 mins



to RSBP Batam, Sekupang
Only 10 mins



to Puri Indah Golf, Sekupang
Only 5 mins



to Starbucks, Tiban
Only 10 mins



to Nagoya
Only 20 mins

OUR LOCATION

ESTABLISHED SURROUNDING

Disclaimer: All contents, forms and images in this Product Knowledge constitute general information related to the product, which is still in the preliminary design stage. Changes in content, forms and images can occur at any time without prior notification, and all rights reserved. This presentation purposes only and cannot be used as legal evidence.



MASTERPLAN SITE & FACILITIES

SITE D: FLOATING COMMERCIAL & RESORT



BEACHSIDE
VILLA & RESORT

Beach Club

Yacht Parking

Chapel

La Fresco

BOH Resort

Floating Pool

Floating Restaurant

The Lawn

Walk Splash

Resort Entrance

Beach Fire Pit
& Sunset Training

La Brisa

The Fountain

Sky SPA

La Playa

The Promenade
700 mtr

PUBLIC FACILITIES

SITE D: FLOATING COMMERCIAL & RESORT AREA



BEACHSIDE

WILSA & PARTNERS



Disclaimer: All contents, forms and images in this Product Knowledge constitute general information related to the product, which is still in the preliminary design stage. Changes in contents, forms and images can occur at any time without prior notification, and full right of the developer. This presentation purposes only and cannot be used as legal evidence.

WHITE SAND

SITE B: RESIDENTIAL AREA



BEACHSIDE

VILLA & SUITE



Entrance

Main Gate

Villa Iluka

Villa Beryl



VILLA BERYL

TYPE 7 (102/91)

FLOORPLAN

VILLA BERYL



BEACHSIDE

VILLA & GALLERY



1st FLOOR

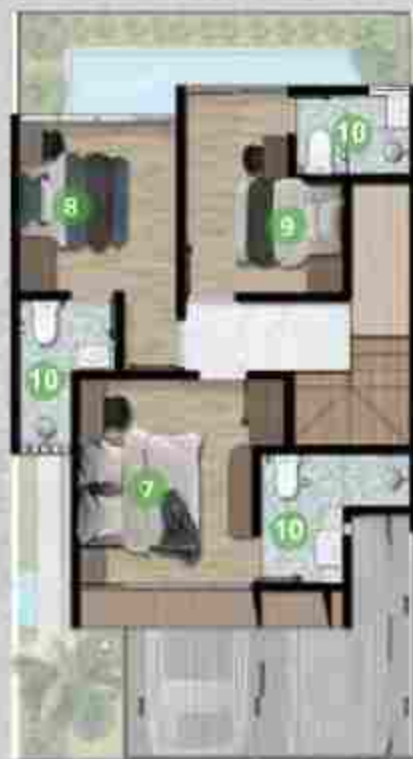

2nd FLOOR

TYPE 7 (102/91)

- 3 Bedroom
- 4 Bathroom

LEGEND

1. Carport
2. Living Room
3. Dining Room
4. Kitchen
5. Bathroom
6. Back Yard
7. Master Bedroom
8. Bedroom 1
9. Bedroom 2
10. Bathroom
11. Pool (Optional)



BEACHSIDE

VILLA & RESORT





MASTER BEDROOM

VILLA BERYL

Disclaimer: All contents, forms and images in this Product Knowledge constitute general information related to the product, which is still in the preliminary design stage. Changes in contents, forms and images can occur at any time without prior notification, and full right of the developer. This presentation purposes only and cannot be used as legal evidence.



BEACHSIDE
VILLA BERYL

MASTER BATHROOM

VILLA BERYL



BEACHSIDE

LIVING ROOM

VILLA BERYL

Disclaimer: All contents, forms and images in this Product Knowledge constitute general information related to the products, which is subject to the availability of design and construction. Changes in content, forms and images can occur at any time without prior notification, and full right of the developer. This presentation is for reference only and does not constitute an offer.



BEACHSIDE
LIVING & TRAVEL

KID'S BEDROOM

VILLA BERYL



VILLA ILUKA

TYPE 7 (90/77)

FLOORPLAN

VILLA ILUKA



BEACHSIDE

VILLA & GALLERY



1st FLOOR



2nd FLOOR

TYPE 7 (90/77)

- 2 Bedroom
- 3 Bathroom

LEGEND

1. Carport
2. Kitchen
3. Dining Room
4. Living Room
5. Bathroom
6. Back Yard
7. Master Bedroom
8. Bedroom
9. Bathroom
10. Pool (Optional)

**BEACHSIDE**
VILLA & RESORT





BEACHSIDE

VILLA & RESORT

LIVING ROOM

VILLA ILUKA

Disclaimer: All contents, forms and images in this Product Knowledge constitute general information related to the product, which is still in the preliminary design stage. Changes in contents, forms and images can occur at any time without prior notification, and full right of the developer. This presentation purposes only and cannot be used as legal evidence.



BEACHSIDE
VILLA & RESORT

MASTER BEDROOM

VILLA ILUKA

Disclaimer: All contents, forms and images in this Product Knowledge document are general information and are not intended to be used as a basis for any financial or investment decision. Changes in content, forms and images can occur without notice. For more information, please contact the relevant department.



BEACHSIDE
VILLA & RESORT

MASTER BATHROOM

VILLA ILUKA



BEACHSIDE
VILLA & RESORT

KID'S BEDROOM

VILLA ILUKA

Disclaimer: All contents, forms and images in this Product Knowledge constitute general information related to the product, which is still in the preliminary design stage. Changes in contents, forms and images can occur at any time without prior notification, and full right of the developer. This presentation purposes only and cannot be used as legal evidence.

SPEIFICATION

BUILDING MATERIAL VILLA



FLOOR FINISH

LIVING & DINNING	: Homogeneous Tile Or Equivalent
BEDROOM	: Stone Polymer Composite (SPC)
BATHROOM	: Homogeneous Tile Or Equivalent
BACK AND FRONT TERRACE	: Glass Reinforced Concrete

WALL FINISH

LIVING & DINNING	: Smooth Plaster in Paint Finish
BEDROOM	: Smooth Plaster in Paint Finish
BATHROOM	: Homogeneous Tile Or Equivalent

CEILING

ALL ROOM	: Gypsum Board Paint Finish
----------	-----------------------------

STAIR

FINISH	: Solid Wood
--------	--------------

STRUCTURE

Reinforced Concrete
Foundation

DOOR & WINDOW

MAIN ENTRANCE DOOR	: Solid Engineering Wood
BEDROOM	: Engineering Wood
BATHROOM	: Aluminium Frame
WINDOW	: Aluminium Frame with Clear Glass

ROOF

FINISH	: Metal Roofng
STRUCTURE	: Light Weight Steel Roof

UTILITIES

Air Conditioner Instalation
Hot and Cold Instalation
Electricity by PLN 15 A
Water Supply by PT. ABH

SMART HOME SYSTEM

Lamp Switch
Indoor & Outdoor CCTV
Smart Digital Door Lock (Main Door)
Smart Cluster

