



# CITRALAKE VILLA

A Truly Lakefront Villa

FINEHOMES  
signature



*We are pleased to introduce*

# 28 TRULY LAKEFRONT VILLAS

*FineHomes Signature by Ciputra Group*





## SITEPLAN

Total development area 5800 sqm

- 9x15
- 9x14.5
- 9x17
- 9x18
- 11x14.5 (9x14.5 Hook)
- 11x15 (9x15 Hook)
- Irregular



## PREMIUM SMART-HOME SYSTEM FOR HIGH QUALITY LIVING

Cutting-edge technology that enhance your wellbeing,  
secure home safety, and optimize energy efficiency.



### Connectivity & Control

Routers / Access Point



### Energy Efficiency

Smart Switches, Smart Plugs, Solar Panel,  
Solar Water Heater



### Safety & Security

Smart Door Lock, Video Intercom, Alarm,  
Panic Button, CCTV



### Comfort & Health

Nanoe X Air Conditioner



### Fresh Air System

Disclaimer: While every effort has been made to ensure the accuracy of the information herein at the time of press, the developer and our agents make no warranty, representation or undertaking whether expressed or implied, nor does it assume any legal liability, whether direct or indirect, or responsibility for the accuracy, completeness or usefulness of any information. The information herein is subject to change and does not form part of any offer contract. All layout are not to scale and all illustration are artist impressions only.

Floor Plan  
**STANDARD TYPE**  
9x15

**Land Area** 135 sqm  
**Building Area** 336 sqm

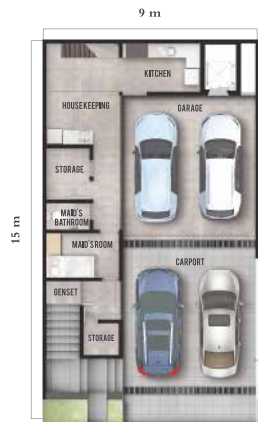

Basement



First Floor



Second Floor



Third Floor

Floor Plan  
**HOOK TYPE**  
11x15

**Land Area** 165 sqm  
**Building Area** 336 sqm

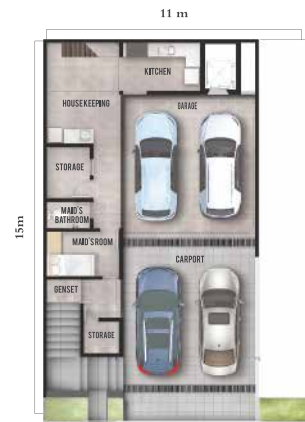

Basement



First Floor



Second Floor



Third Floor



4+1

4+1

4

Disclaimer: While every effort has been made to ensure the accuracy of the information herein at the time of press, the developer and our agents make no warranty, representation or undertaking whether expressed or implied, nor does it assume any legal liability, whether direct or indirect, or responsibility for the accuracy, completeness or usefulness of any information. The information herein is subject to change and does not form part of any offer contract. All layout are not to scale and all illustration are artist impressions only.

# BUILDING SPECIFICATIONS

|                        |   |                               |   |                    |   |
|------------------------|---|-------------------------------|---|--------------------|---|
| <b>Foundation</b>      | Mini Pile   | <b>Floor</b>                  |   | <b>Window</b>      | Aluminium Frame with Low-E Glass  |
| <b>Structure</b>       | Reinforced Concrete   | <i>Carport &amp; Entrance</i> | Ceramic Tile                                    | <b>Sanitary</b>    | TOTO  |
| <b>Roof</b>            | Lightweight Steel with Bitumen Shingles,<br>Concrete Flat Roof<br>(TOYOTA Housing System) | <i>Terrace</i>                | Sintered Stone Tile                             | <b>Lift</b>        | SCHINDLER   |
| <b>Ceiling</b>         | Painted Gypsum Board  | <i>Main Floor</i>             | Sintered Stone Tile                             | <b>Electricity</b> | 11.000 VA   |
| <b>Exterior Wall</b>   | Plastered Paint Stone & Wood Artificial Cladding  | <i>Staircase</i>              | Granite   | <b>Water</b>       | WTP   |
| <b>Interior Wall</b>   |   | <i>Master Bedroom</i>         | Laminate Flooring                               | <b>Features</b>    | Smart Home System (Smart Door Lock, Video<br>Intercom, CCTV, Panic Button, Alarm, Smart Plug,<br>Smart Switch, IR Remote) |
| <i>General Wall</i>    | Plastered Paint   | <i>Guest Bedroom</i>          | Laminate Flooring                               |                    | Solar Panel   |
| <i>Master Bathroom</i> | Marble with Mosaic Tile Accent  | <i>Kids Bedroom</i>           | Laminate Flooring                               |                    | Solar Water Heater  |
| <i>Guest Bathroom</i>  | Sintered Stone Lab  | <i>Master Bathroom</i>        | Marble with Homogenous Tile Accent              |                    | Potable Water   |
| <i>Kids Bathroom</i>   | Homogenous Tile   | <i>Guest Bathroom</i>         | Sintered Stone Tile with Homogenous Tile Accent |                    | AC Split (PANASONIC CAMS) for All Bedrooms<br>except Service Room   |
| <i>Service</i>         | Ceramic Tile  | <i>Kids Bathroom</i>          | Sintered Stone Tile with Homogenous Tile Accent |                    | AC Split Duct (PANASONIC CAMS) for Living and<br>Dining Room  |
|                        |   | <i>Balcony</i>                | Homogenous Tile                                 |                    | Kitchen Set for Dry and Wet Kitchen   |
|                        |   | <i>Service &amp; Garage</i>   | Ceramic Tile                                    |                    | Vanity Cabinet for All Bathroom except Service Room   |
|                        |   | <b>Door</b>                   |   |                    |   |
|                        |   | <i>Main Entrance</i>          | Engineered Wood                                 |                    |   |
|                        |   | <i>Interior</i>               | Engineered Wood                                 |                    |   |

# PARTNERS

|  |   |  |   |
|--|---|--|---|
| <br><b>HADIVINCENT ARCHITECTS</b>                           | <br><b>hadiprana</b><br>design  | <br><b>Panasonic</b> | <br><b>Schindler</b>   |
| <b>HADIVINCENT</b><br>Architecture Consultant  | <b>GRAHACIPTA HADIPRANA</b><br>Design Consultant  | <b>PANASONIC</b><br>Smart Home System  | <b>SCHINDLER</b><br>Home Lift   |
| <br><b>Panasonic</b><br>COMPLETE AIR<br>MANAGEMENT SYSTEM | <br><b>TOYOTA HOUSING ROOF</b> | <b>TOTO</b>  | <br><b>YKK</b><br>AP |
| <b>PANASONIC CAMS</b><br>Air Conditioner   | <b>TOYOTA HOUSING</b><br>Roofing System   | <b>TOTO</b><br>Sanitary  | <b>YKK</b><br>Aluminium   |

Disclaimer: While every effort has been made to ensure the accuracy of the information herein at the time of press, the developer and our agents make no warranty, representation or undertaking whether expressed or implied, nor does it assume any legal liability, whether direct or indirect, or responsibility for the accuracy, completeness or usefulness of any information. The information herein is subject to change and does not form part of any offer contract. All layout are not to scale and all illustration are artist impressions only.



## MARKETING GALLERY

Jl. Boulevard Citra 6, CitraGarden City, Jakarta Barat



**CITRALAKE VILLA**  
A Truly Lakefront Villa

[www.citralakevilla.com](http://www.citralakevilla.com)

FINEHOMES  
signature

