

THE PRIME

9x18m/9x19m

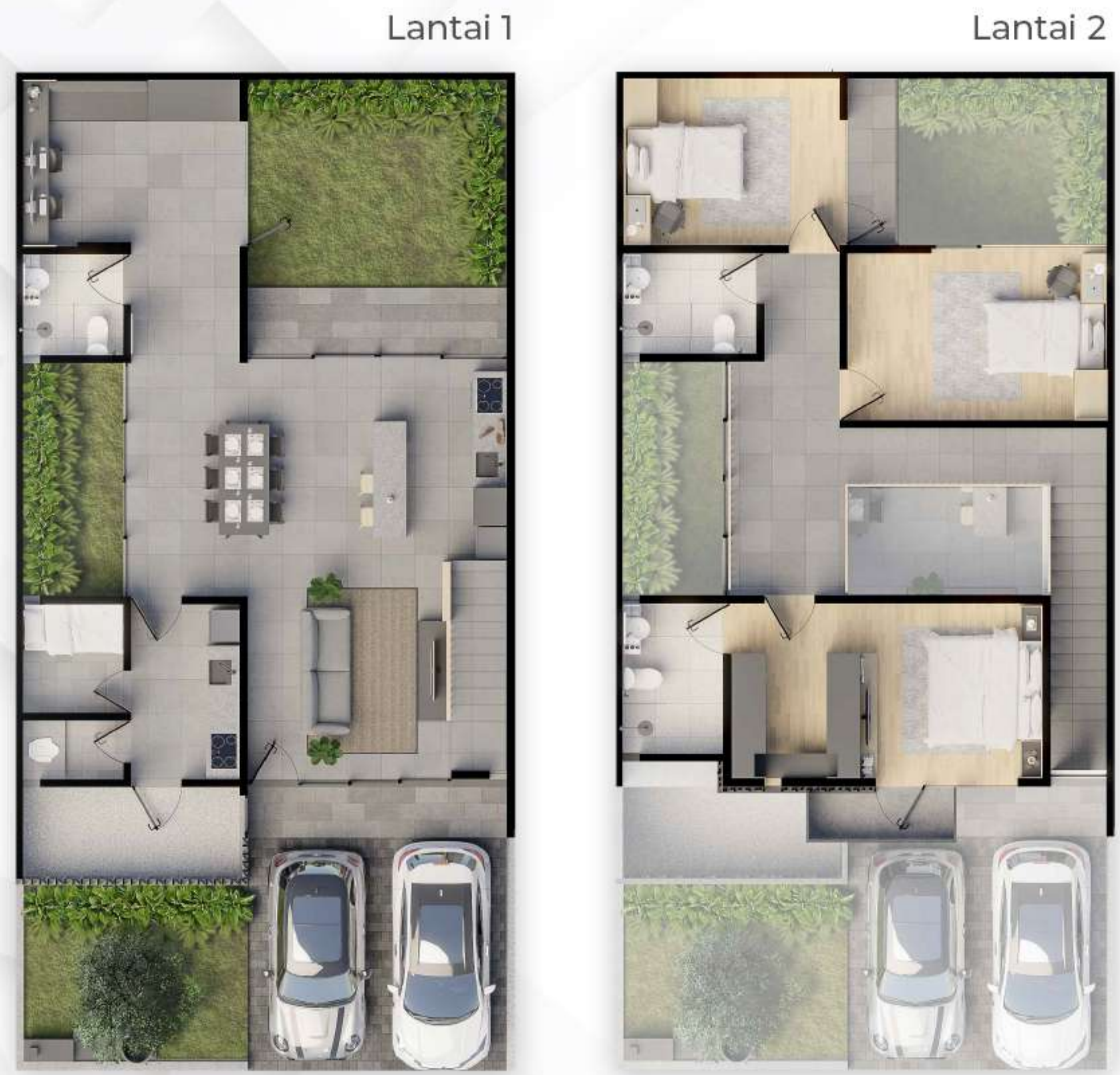

- Land **162**
- Building **185**
- 4+1** Bedroom
- 3+1** Bathroom
- 1** Living Room
- 2** Car Port

MORNINGTON

HOOK

8x13m/8x14.5m



- | Land | Building | 4 | 3 | 1 | 2 |
|------------|------------|---------|----------|-------------|----------|
| 104 | 130 | Bedroom | Bathroom | Living Room | Car Port |
| 116 | 130 | | | | |

MORNINGTON

8x13m/8x14.5m



- Land **104/116**
- Building **130/130**
- 4** Bedroom
- 3** Bathroom
- 1** Living Room
- 2** Car Port



PT. griyo mapan santoso
REAL ESTATE & HOUSING DEVELOPMENT

Brighton
Project

X XAVIER
MARKS

galaxy



HAMPTON

7x13m



- Land **91**
- Building **120**
- 4 Bedroom
- 3 Bathroom
- 1 Living Room
- 2 Car Port

CARLTON

6x13m



- Land **78**
- Building **105**
- 3 Bedroom
- 2 Bathroom
- 1 Living Room
- 1 Car Port

BELMONT

5x14.5m



- Land **72**
- Building **90**
- 3 Bedroom
- 2 Bathroom
- 1 Living Room
- 1 Car Port