



# HAMPTON EAST

@ Manhattan District

- ### PRIMARY FEATURES
- Elevator Compatible
  - Mini Balcony For Service Area
  - Grand Canopy
  - High Ceiling 5.4m
  - Double Facade
  - Mezzanine Include
  - Spacious Parking Area



### STUDIO LOFT - TYPE A



### TECHNICAL SPECIFICATION

<ul style="list-style-type: none"> <li>• Pondasi : Tiang pancang (Mini pile)</li> <li>• Struktur kolom, balok, dak, sloof, ring balok, tangga : Beton bertulang</li> <li>• Bangkai atap : Rangka baja ringan (Zincatam)</li> <li>• Penutup atap : Atap metal (Zincatam) + aluminium foil</li> <li>• Lantai utama : Homogenous tile 60x60 (Type Studio Loft)</li> <li>• Lantai teras &amp; Balkon : Homogenous tile 60x60 anti slip (Type Studio Loft)</li> <li>• Lantai teras : Homogenous tile 60x60 anti slip (Type Reguler)</li> <li>• Lantai mezzanine : Stone plastic composite (Type Studio Loft)</li> <li>• Lantai KM/WC : Homogenous tile 60x60 anti slip (Type Studio Loft)</li> <li>• Dinding KM/WC : Keramik 30x30 anti slip (Type Reguler)</li> <li>• Dinding dalam : Homogenous tile 60x60 (Type Studio Loft)</li> <li>• Dinding luar : Keramik 30x30 anti slip (Type Reguler)</li> <li>• Sanitary : Homogenous tile 60x60 anti slip (Type Studio Loft)</li> <li>• Plafond dalam : Keramik 30x30 (Type Reguler)</li> <li>• Plafond luar &amp; toilet : Homogenous tile 60x60 (Type Studio Loft)</li> <li>• Railing tangga : Keramik 30x30 (Type Reguler)</li> <li>• Railing balkon : Keramik 30x30 (Type Reguler)</li> <li>• Railing mezzanine : Keramik 30x30 (Type Reguler)</li> <li>• Pintu/Jendela lainnya : Keramik 30x30 (Type Reguler)</li> <li>• Pintu KM/WC : Keramik 30x30 (Type Reguler)</li> <li>• Plafond dalam : Keramik 30x30 (Type Reguler)</li> <li>• Plafond luar &amp; toilet : Keramik 30x30 (Type Reguler)</li> <li>• Railing tangga : Keramik 30x30 (Type Reguler)</li> <li>• Railing balkon : Keramik 30x30 (Type Reguler)</li> <li>• Railing mezzanine : Keramik 30x30 (Type Reguler)</li> </ul>	<ul style="list-style-type: none"> <li>• Pantry : Disediakan instalasi air bersih dan air kotor (Type Studio Loft)</li> <li>• Meja pantry : Meja beton fin homogenous tile 60x60 (Type Reguler)</li> <li>• Kanoji teras depan : Kaca, rangka baja dan besi hollow (Type Studio Loft)</li> <li>• Kanoji drop off : Kaca, rangka baja dan besi hollow (Type Studio Loft)</li> <li>• Ornamen fasad : Dekoratif panel</li> <li>• LIT (opsional) : Kapasitas maksimal 450kg (Type Studio Loft A)</li> <li>• Grease trap portabel : Kapasitas 50 liter (Type Studio Loft)</li> <li>• Kapasitas 30 liter (Type Reguler)</li> </ul>
<ul style="list-style-type: none"> <li>• Instalasi : Instalasi fiber optic (Type Studio Loft &amp; Reguler)</li> <li>• Telepon : Instalasi fiber optic (Type Studio Loft &amp; Reguler)</li> <li>• Air bersih : Suplai Perumdam + GWT 1.000 L + tower 1.000 L + Pompa (Type Studio Loft)</li> <li>• Air kotor : Suplai Perumdam + Tower 550 L (Type Reguler)</li> <li>• Septictank biologi 2.000 L (Type Studio Loft)</li> <li>• Septictank biologi 1.000 L (Type Reguler)</li> </ul>	<ul style="list-style-type: none"> <li>• SPECIAL FEATURES : IF CCTV, AIR CONDITIONER</li> </ul>

### ORIENTATION MAP



PARAMOUNT PLAZA  
Jl. Boulevard Raya Gading Serpong Kav. 1 Gading Serpong, Tangerang - 15890  
paramount-land.com



## STUDIO LOFT - TYPE B



5 X 20 Meter LT: 100 LB: 287 | 5 X 19 Meter LT: 95 LB: 287

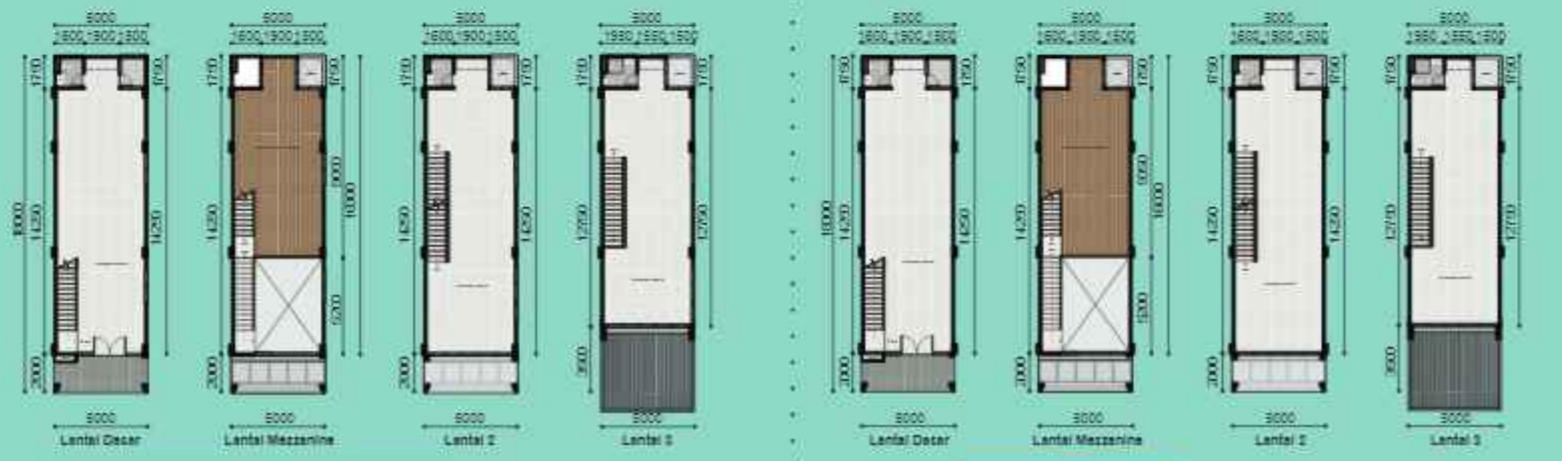

5 X 17 Meter LT: 85 LB: 247 | 5 X 18 Meter LT: 90 LB: 278



5 X 16 Meter (CORNER TYPE) LT: 80 LB: 238 | 5 X 18 Meter LT: 90 LB: 278



5 X 16 Meter LT: 80 LB: 238 | 5 X 15 Meter LT: 75 LB: 218

## REGULAR TYPE

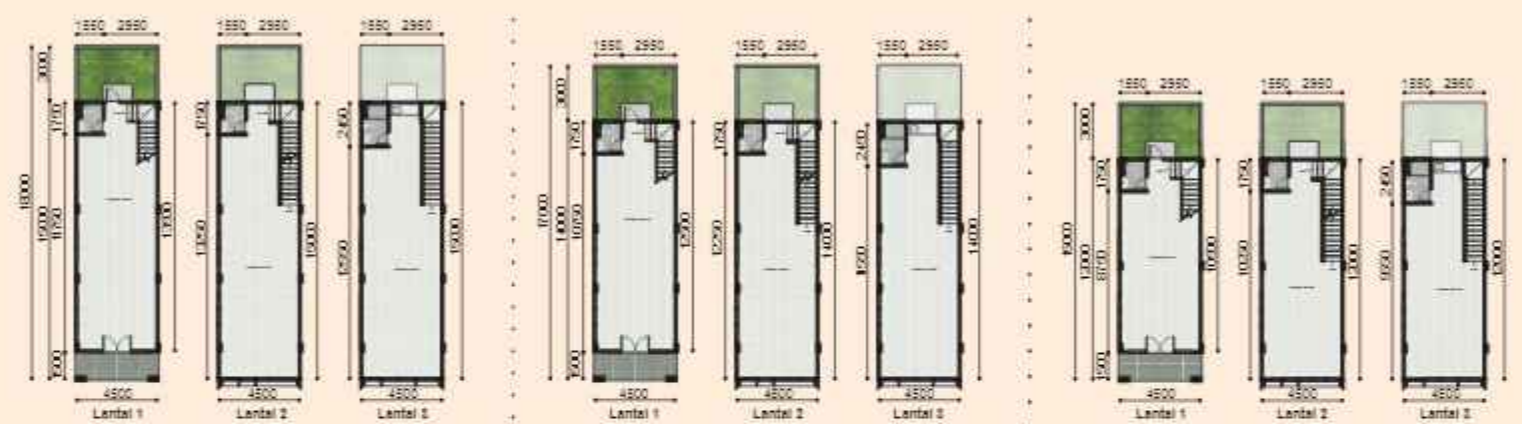

4,5 X 18 Meter (CORNER TYPE) LT: 81 LB: 203 | 4,5 X 17 Meter (CORNER TYPE) LT: 76,5 LB: 190 | 4,5 X 15 Meter (CORNER TYPE) LT: 67,5 LB: 163

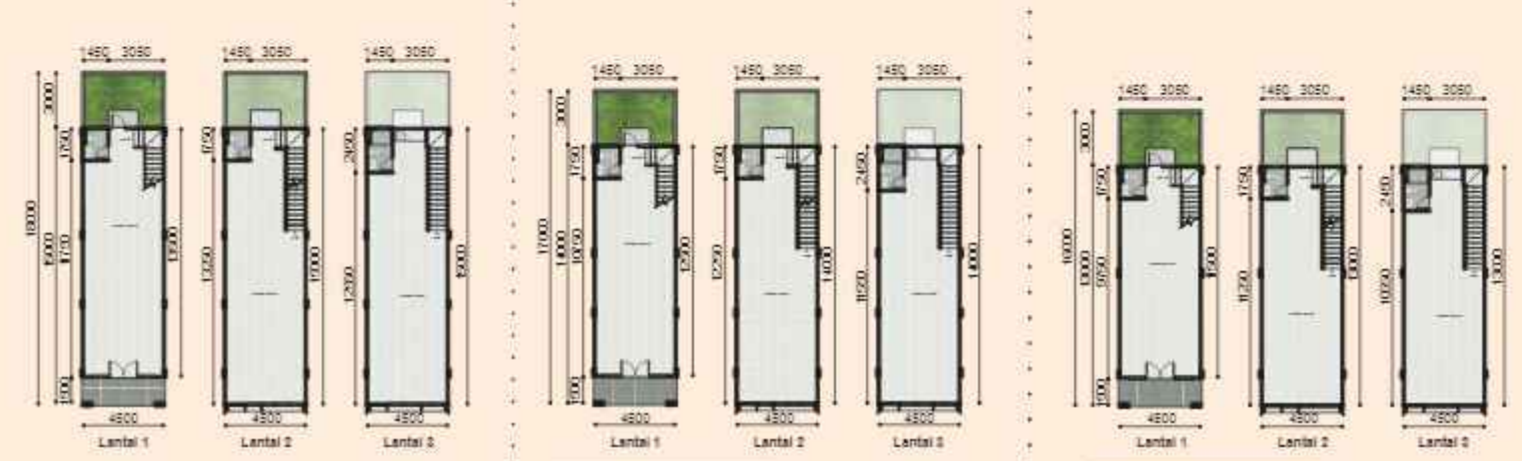

4,5 X 18 Meter LT: 81 LB: 203 | 4,5 X 17 Meter LT: 76,5 LB: 190 | 4,5 X 16 Meter LT: 72 LB: 176



4,5 X 15 Meter LT: 67,5 LB: 163 | 4,5 X 12 Meter LT: 54 LB: 162 | 4,5 X 11 Meter LT: 49,5 LB: 148,5



4,5 X 9,5 Meter LT: 42,75 LB: 128,25



### STUDIO LOFT TYPE

- TYPE A**
- 5 x 18 - Corner Type (3,5 Lantai)
  - 5 x 20 (3,5 Lantai)
  - 5 x 17 (3,5 Lantai)
  - 5 x 16 - Corner Type (3,5 Lantai)
  - 5 x 19 (3,5 Lantai)
  - 5 x 16 (3,5 Lantai)
  - 5 x 15 - Corner Type (3,5 Lantai)
  - 5 x 18 (3,5 Lantai)
  - 5 x 15 (3,5 Lantai)

### REGULAR TYPE

- 4,5 x 18 - Corner Type (3 Lantai)
- 4,5 x 18 (3 Lantai)
- 4,5 x 15 (3 Lantai)
- 4,5 x 11 (3 Lantai)
- 4,5 x 17 - Corner Type (3 Lantai)
- 4,5 x 17 (3 Lantai)
- 4,5 x 12 (3 Lantai)
- 4,5 x 9,5 (3 Lantai)
- 4,5 x 15 - Corner Type (3 Lantai)
- 4,5 x 16 (3 Lantai)

- Sirkulasi Kendaraan
- Titik PJU
- Panel SKTR
- Gardu Listrik
- Elevasi

### STUDIO LOFT TYPE

- TYPE A DOUBLE FACADE** | **TYPE B SINGLE FACADE**

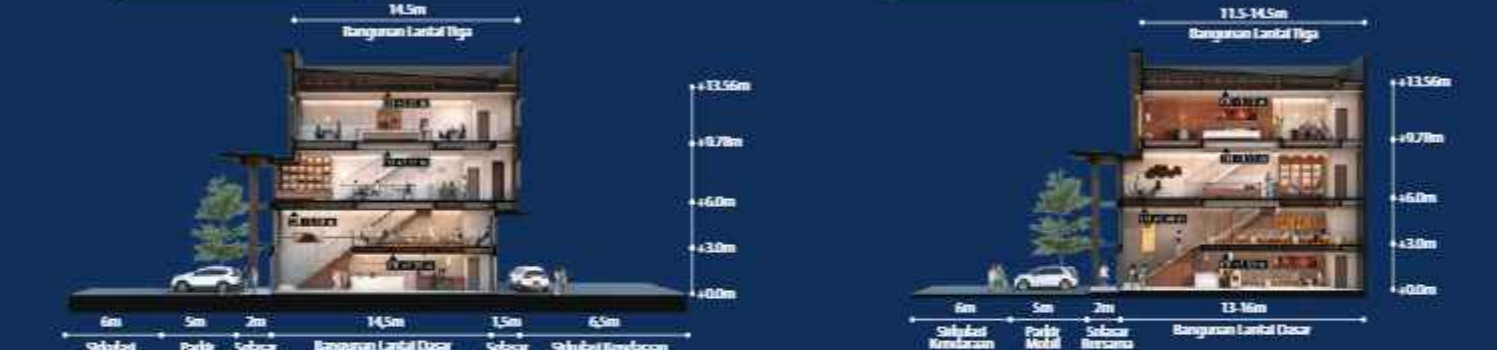

### REGULAR TYPE

